

### WIPER/DIRECTIONAL/LIGHT SWITCH

#### REMOVAL AND INSTALLATION

Disconnect battery ground cable.

Center steering wheel and front wheels.

Pry horn button off steering wheel (3).

Remove two horn button springs (4). Remove nut (1) holding wheel (3) to shaft (2).

Mark steering wheel and steering shaft for installation reference. Pull wheel off shaft.

1. Nut 2. Steering shaft 3. Steering wheel 4. Horn button springs

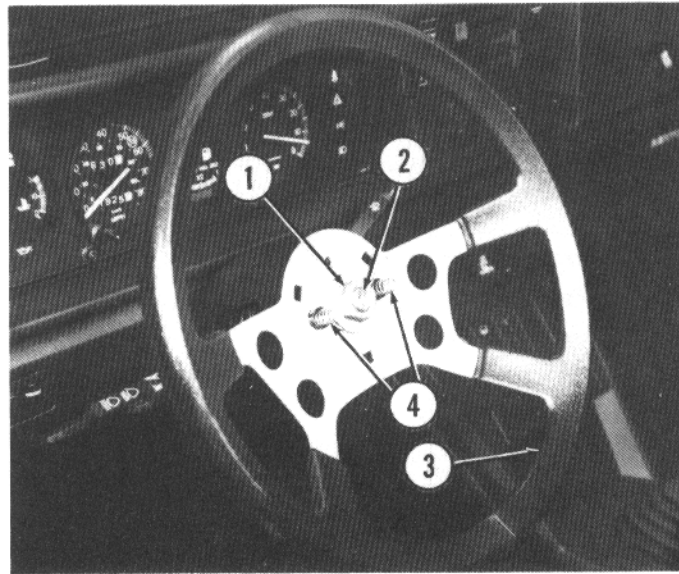

Remove four screws (2 and 3) to remove upper and lower steering column covers (1).

1. Steering column covers 2. Screws 3. Screw

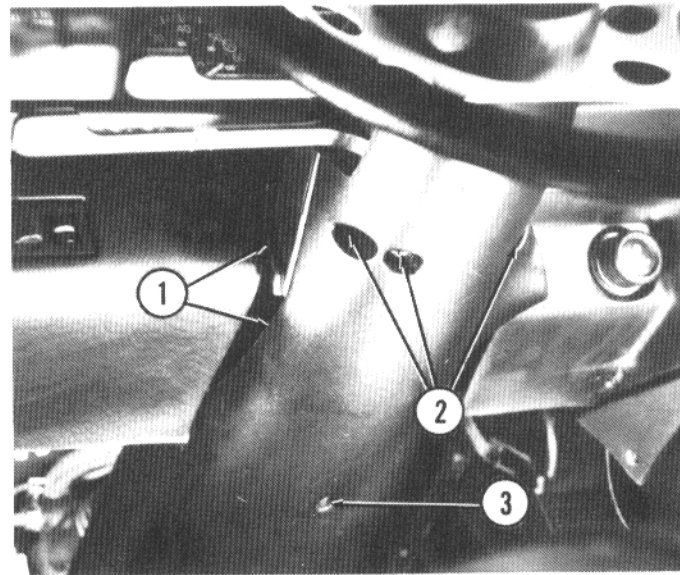

Loosen bolt (2) holding switch assembly (1) to shaft housing (3). Slide switch assembly off steering column.

Disconnect electrical connectors and remove switch assembly. Install in reverse order.

1. Switch 2. Bolt 3. Shaft housing

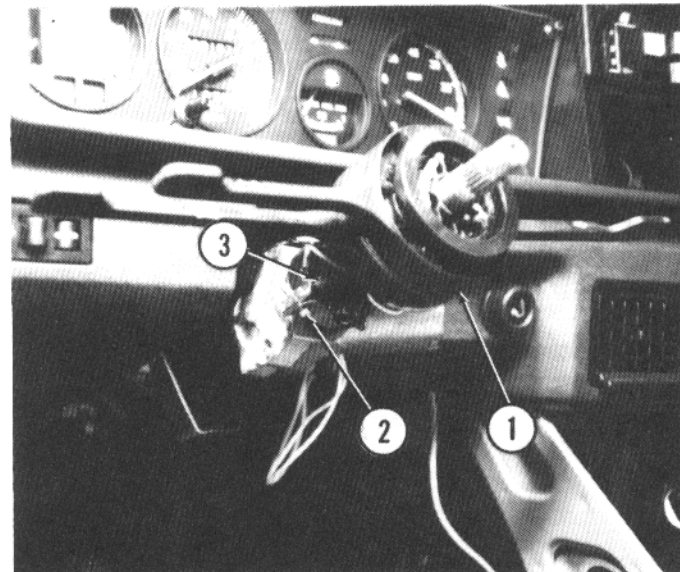

## HORNS

### REMOVAL AND INSTALLATION

From front luggage compartment, remove headlight access panel.

Working inside headlight compartment, disconnect electrical connector from horn (3).

Remove bolt (1) holding horn bracket (2) to body and remove horn (3) complete with bracket.

Repeat procedure on opposite side to remove remaining horn.  
Install in reverse order.

1. Bolt 2. Bracket 3. Horn

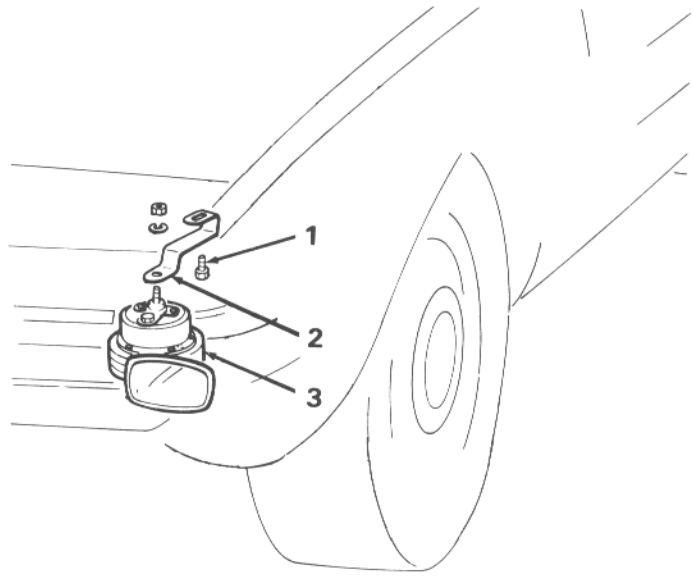

### REMOVAL AND INSTALLATION

Disconnect battery ground cable.

Working in front luggage compartment, remove four screws and one bolt holding left grille and remove grille.

Uncouple speedometer cable (1) by sliding sleeve (4) on coupler (3) toward front of vehicle.

Remove grommet (2) from firewall.

1. Cable 2. Grommet 3. Coupler 4. Sleeve

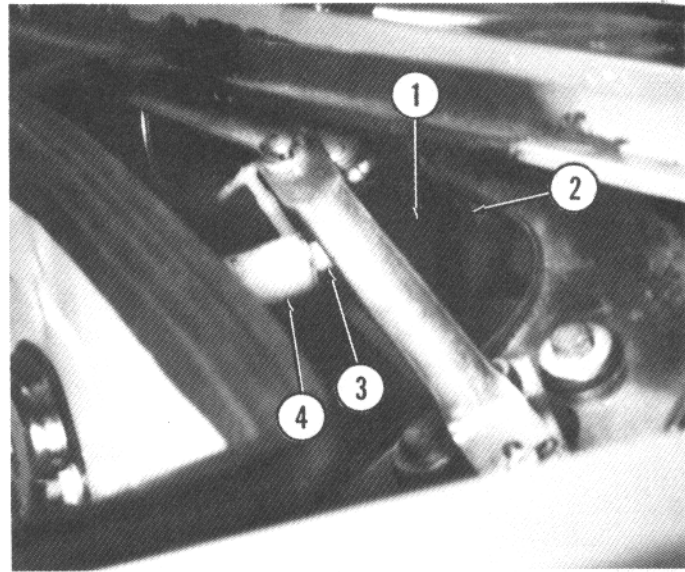

Remove five Allen bolts (1) holding instrument cluster (2) to support (3).

Pull instrument cluster out of panel far enough to gain access to rear of cluster.

**NOTE:** It may be necessary to guide cable coupler through firewall hole.

1. Allen bolts 2. Instrument cluster 3. Support

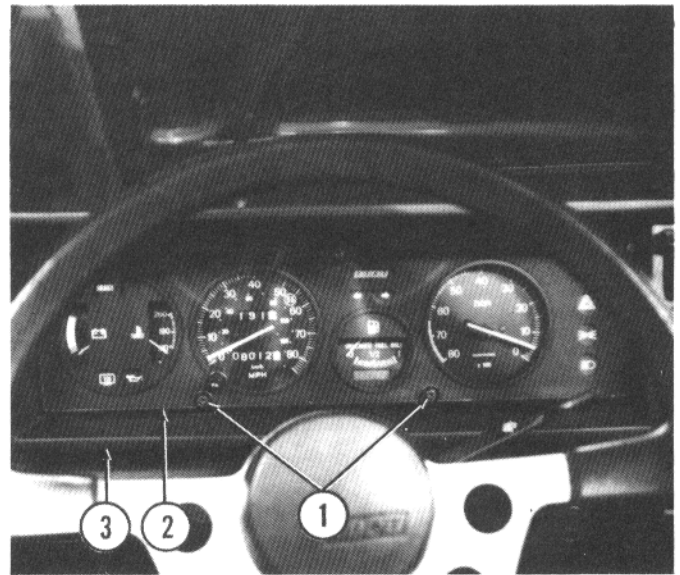

Unplug three electrical connectors (1, 2 and 3) from instrument cluster.

On vehicles with fuel injection, cut wire (4).

Remove instrument cluster.

To install, reverse removal procedure. On vehicles with fuel injection, splice together wire cut during removal.

1. Connector 2. Connector 3. Connector 4. Wire

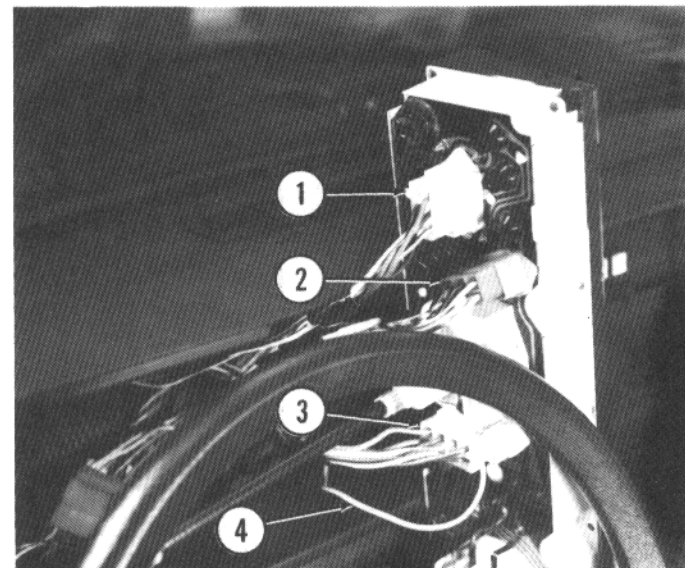

## WINDSHIELD WIPER MOTOR

### REMOVAL AND INSTALLATION

**NOTE:** Wipers should be in "park" position.

Disconnect wiper motor connector (7).

Remove two nuts (8) and both halves of retaining plate (10). Push connector through hole in cowl.

Remove left wiper arm (11). Remove nut (1), spacer and rubber washer from wiper arm shaft.

Remove nut (4) holding motor arm (9) to shaft and remove motor arm.

Remove two bolts (6) and washers holding bracket (2).

Remove bolts (3) and washers holding wiper motor (5) to bracket.

Lift bracket until motor can be maneuvered out of vehicle.

Install in reverse order.

1. Nut 2. Bracket 3. Bolts 4. Nut 5. Wiper motor 6. Bolts  
7. Electrical connector 8. Nuts 9. Arm 10. Retaining plate  
11. Wiper arm

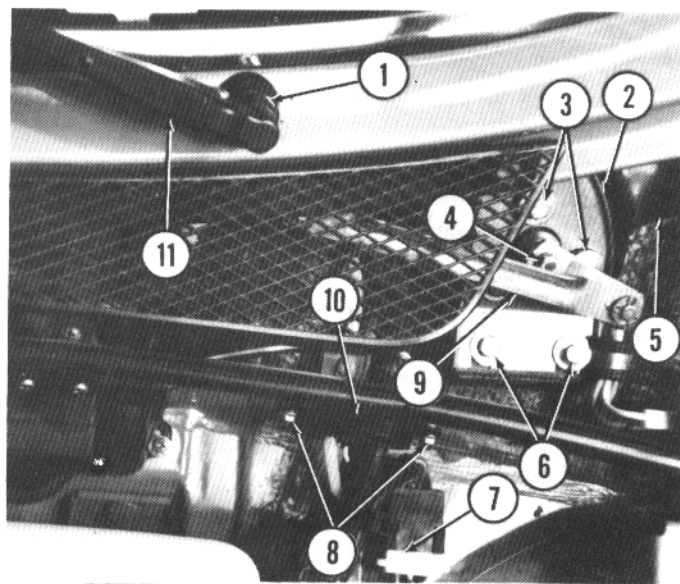

## WIPER ARM ADJUSTMENT

With wiper arms in "park" position, check arm height at wiper blade.

Check that dimension "A" is 2.4 to 3.3 in. (60 to 85 mm) and dimension "B" is 2.6 to 3.3 in. (65 to 85 mm).

If necessary, remove wiper arms and reposition them to correct park position.

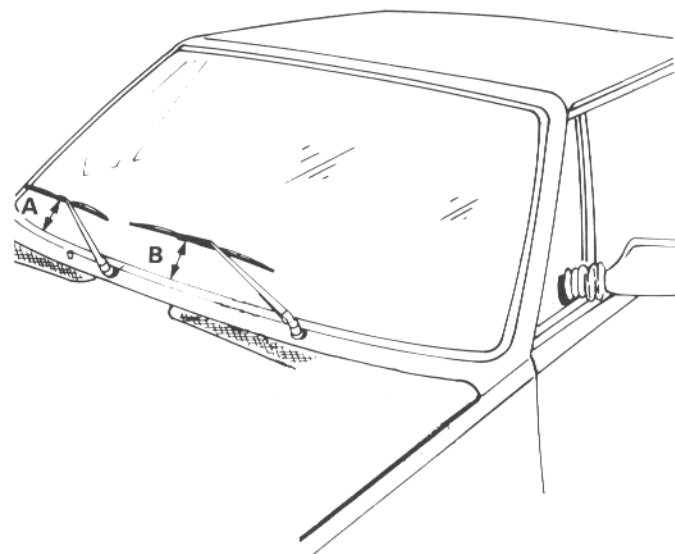

## WINDSHIELD WASHER RESERVOIR

### REMOVAL AND INSTALLATION

Disconnect hose (3) from motor (5) and plug opening to prevent leakage.

Disconnect electrical connector (4) from motor.

Remove nut (1) holding reservoir (2) and remove reservoir.

Install in reverse order.

1. Nut 2. Reservoir 3. Hose 4. Connector 5. Motor

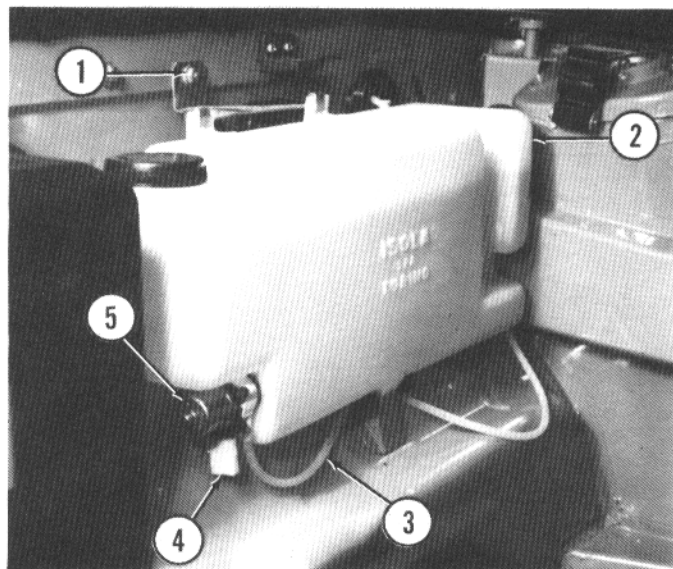

## HEATED REAR WINDOW

### REPAIR

When repairing an open metallic conductor attached to rear window, it is not necessary to remove glass.

The repair can be accomplished with a special kit made for this purpose or a silver paint with metallic content.

Clean area around break.

Mix paint thoroughly.

Mask off each side of the break. Carefully apply paint to break with a camel hair brush as shown.

Allow to dry for about 4 to 5 hours. A source of low temperature heat (hair dryer, infrared lamp) will shorten drying time.

**CAUTION:** Do not turn on rear window heater until repair is completely dry.

